

Design and Development Principles

4. Create a NEW FRONTAGE FOR THE MUNICIPAL AND CIVIC DISTRICT along Huntsville Ave.

Preliminary Recommendations:

- *Boulevard Huntsville Ave from Thompson Street to Old Missouri Road.*
- *Re-align Spring St and open two ways.*

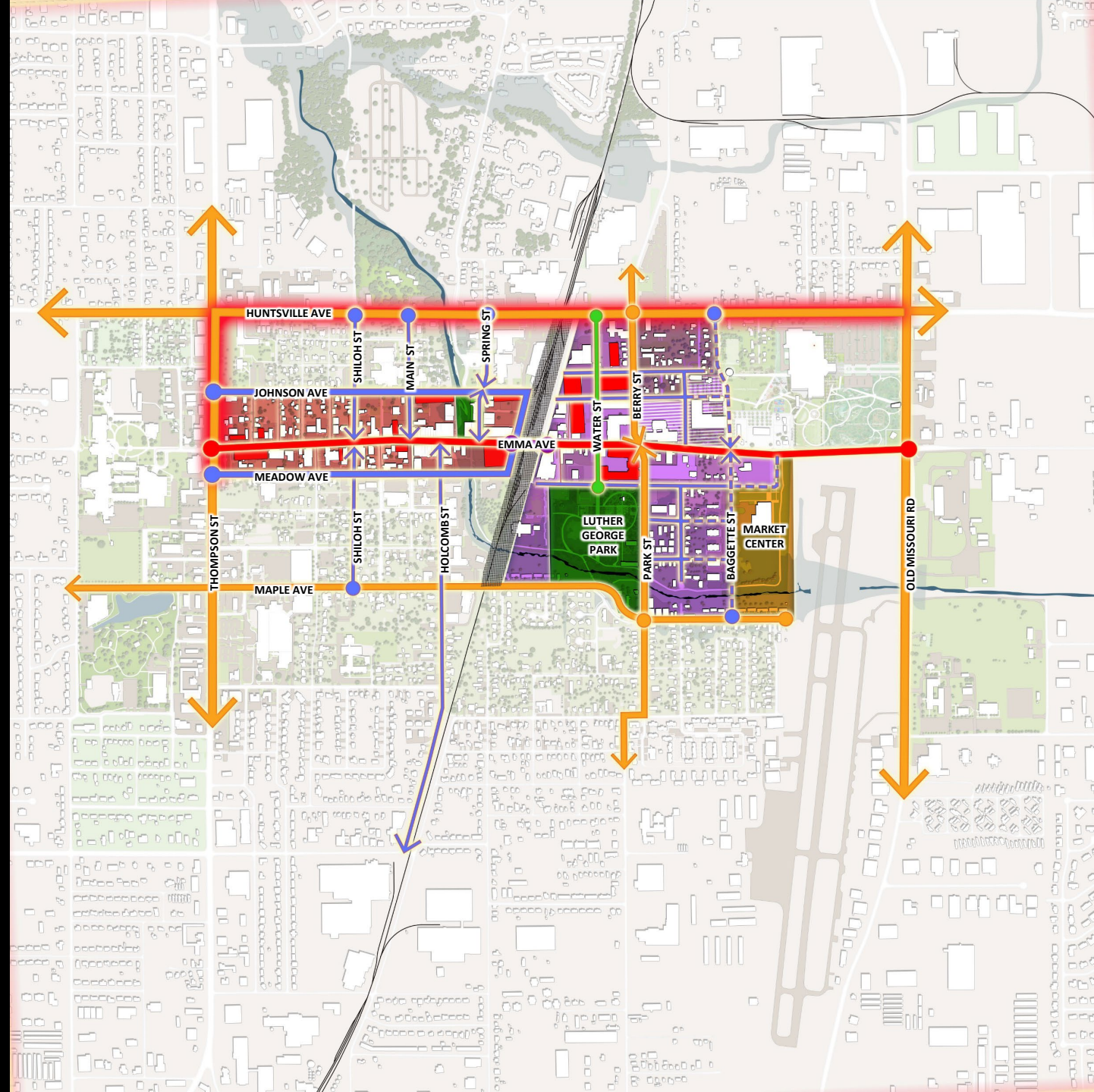

Design and Development Principles

4. Create a NEW FRONTAGE FOR THE MUNICIPAL AND CIVIC DISTRICT along Huntsville Ave.

Preliminary Recommendations:

- *Boulevard Huntsville Ave from Thompson Street to Old Missouri Road.*
- *Re-align Spring St and open two ways.*
- *Create primary gateways into downtown along Shiloh St., Main St., Spring Street, Water St., Park St., Berry St. and the new frontage road.*
- *Close Mill St and expand the greenspace between Shiloh Museum and the Municipal Center.*

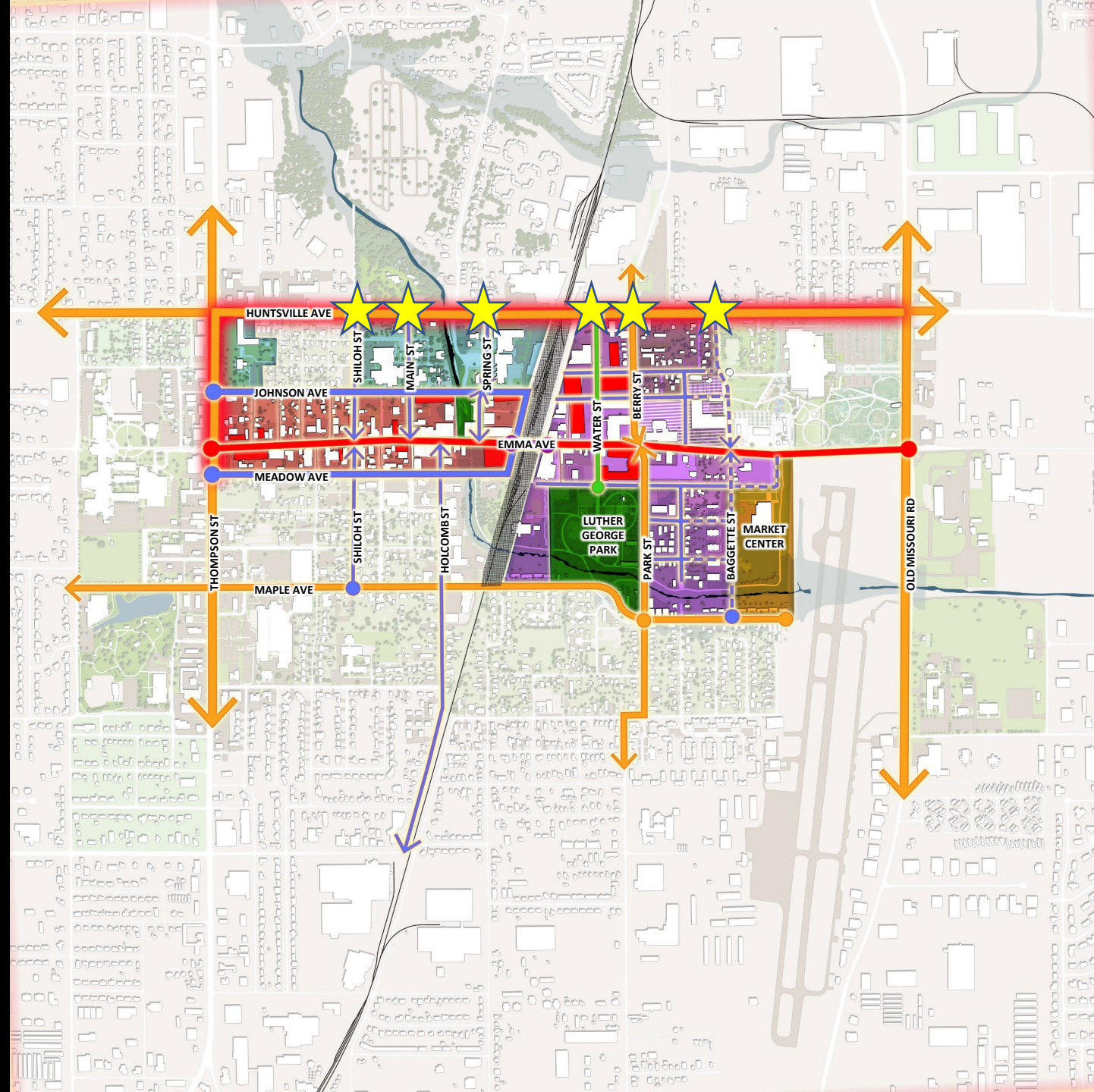

Design and Development Principles

5. Develop the 214 BUILDING as an Arts & Culture venue to provide community-wide programs.

214 building, Springdale, AR

- *Gallery Space*
- *Black Box Theater*
- *Auditorium*
- *Classrooms*

The Creative Exchange Fund

- *Artist Residencies*
- *Call for Curators*
- *Mixtape Series*
- *Producers Fund*
- *The Platform*

“24 live performance productions, 24 indoor and outdoor art installations, and over 20 community facing workshops and gatherings for a total of 80 activations in 2022.”



Design and Development Principles

5. Develop the 214 BUILDING as an Arts & Culture venue to provide community-wide programs.

Preliminary Recommendations:

- *Expand the uses and the Main and Meadow street presence of the 214 building.*
- *Establish Main St. as an active connector from the 214 building to Emma Ave.*
- *Reconfigure and landscape Holcomb St and Shiloh St as gateways from Maple Ave.*

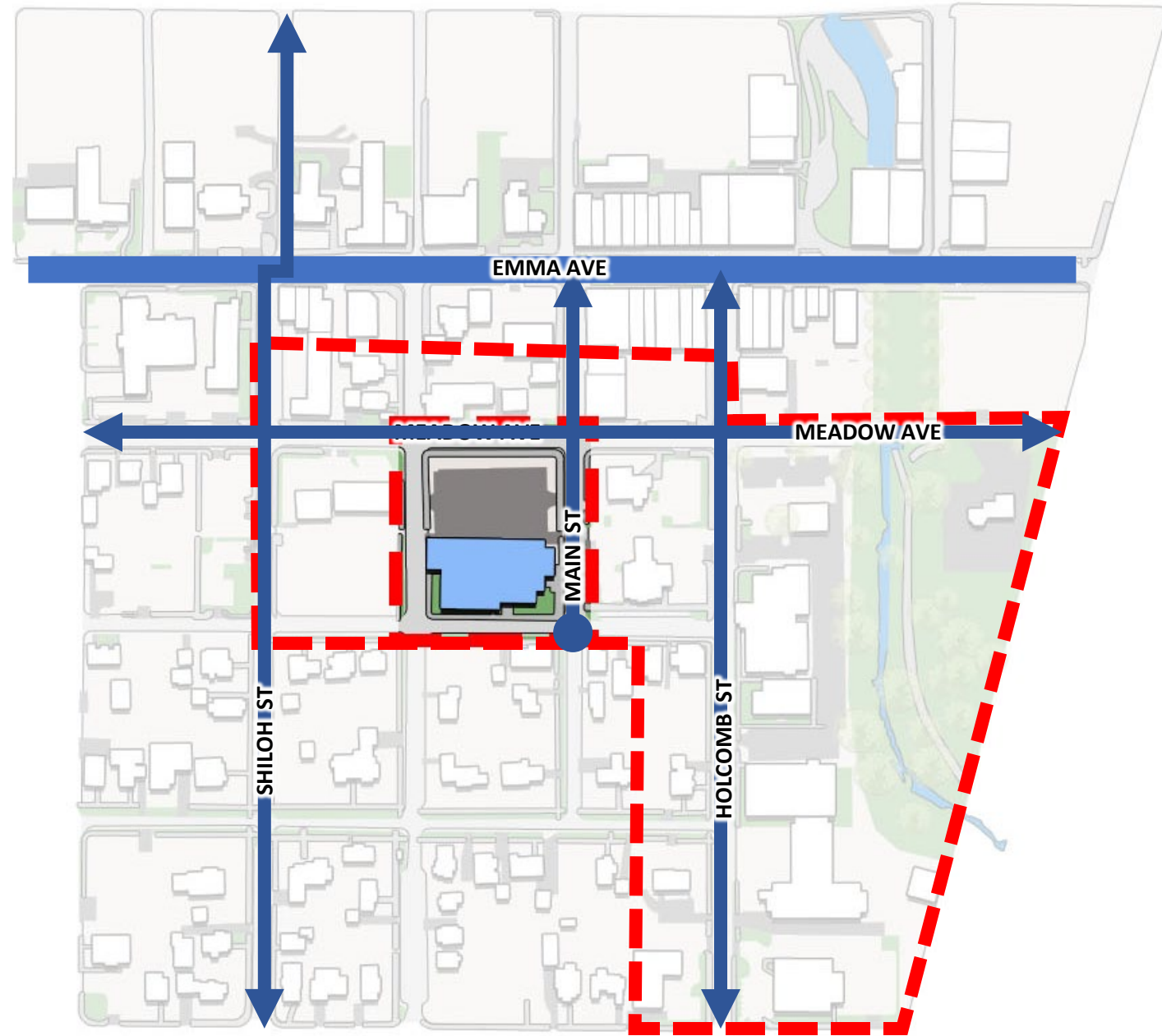

Design and Development Principles

5. Develop the 214 BUILDING as an Arts & Culture venue to provide community-wide programs.

Preliminary Recommendations:

- *Expand the uses and the Main and Meadow street presence of the 214 building.*
- *Establish Main St. as an active connector from the 214 building to Emma Ave.*
- *Reconfigure and landscape Holcomb St and Shiloh St as gateways from Maple Ave.*

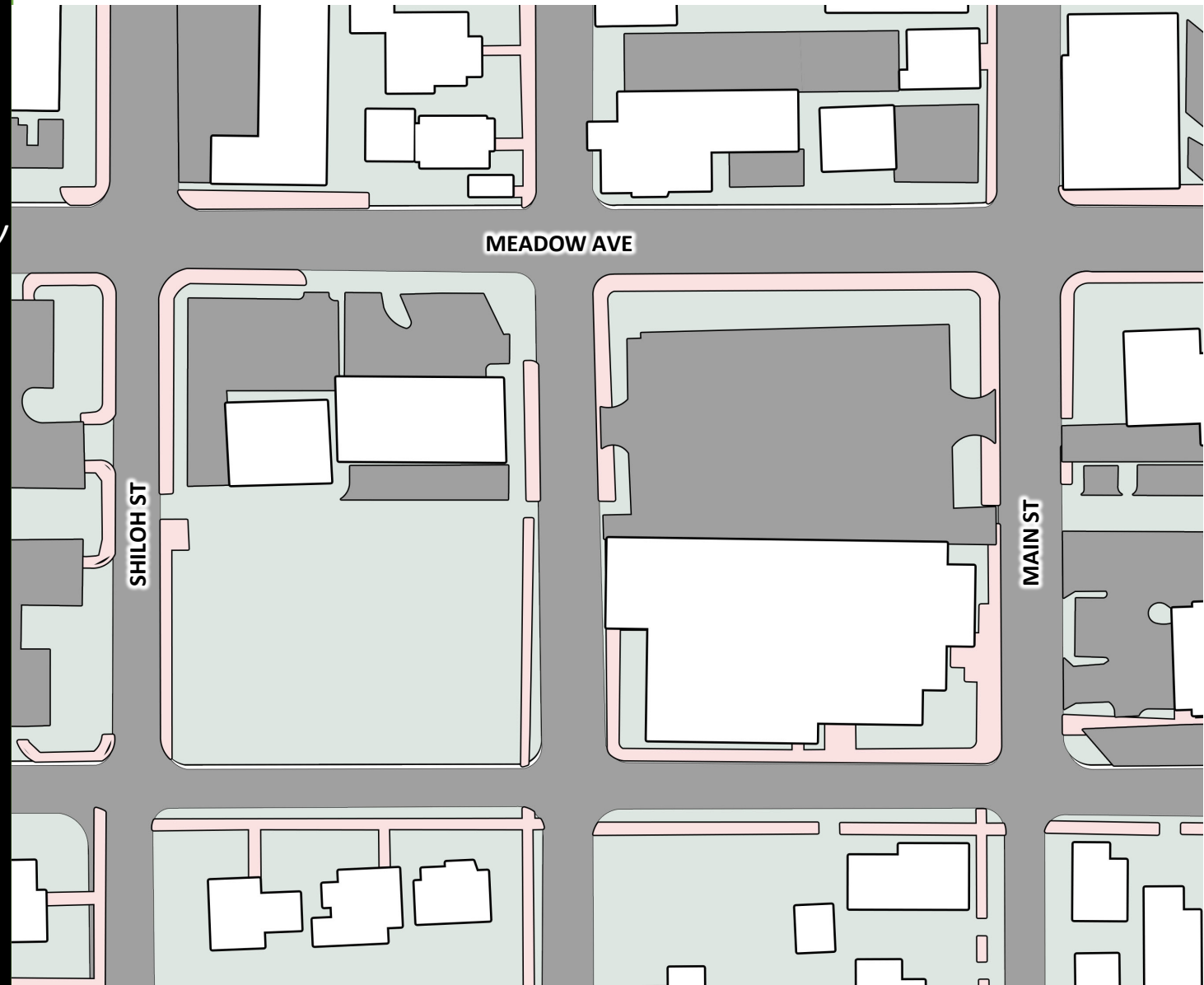

Design and Development Principles

5. Develop the 214 BUILDING as an Arts & Culture venue to provide community-wide programs.

Preliminary Recommendations:

- *Expand the uses and the Main and Meadow street presence of the 214 building.*
- *Establish Main St. as an active connector from the 214 building to Emma Ave.*
- *Reconfigure and landscape Holcomb St and Shiloh St as gateways from Maple Ave.*
- *Develop a parking structure and liner building with artist studio's and housing west of the 214 building.*
- *Close Blair St between Meadow Ave and Grove Ave.*



Design and Development Principles

5. Develop the 214 BUILDING as an Arts & Culture venue to provide community-wide programs.

Theater Squared, Fayetteville, AR

- 50,000 SF
- State-of-the art theatres
- Eight artist apartments
- A rehearsal space
- Offices, education and community spaces
- On-site workshops,
- Outdoor terraces at three levels,
- An always-open café/bar at the active corner.



Design and Development Principles

5. Develop the 214 BUILDING as an Arts & Culture venue to provide community-wide programs.

Santa Monica Civic Center and Parking Structure, Santa Monica, CA

- *Acts as the gateway to the civic center*
- *900 parking spots*
- *6 levels*
- *Shared mobility bike and scooter hub*
- *Street level retail*
- *Street level café*
- *Garden*
- *Host to community events:*
 - *Farmers market*
 - *Public Art*
 - *Skate Park*

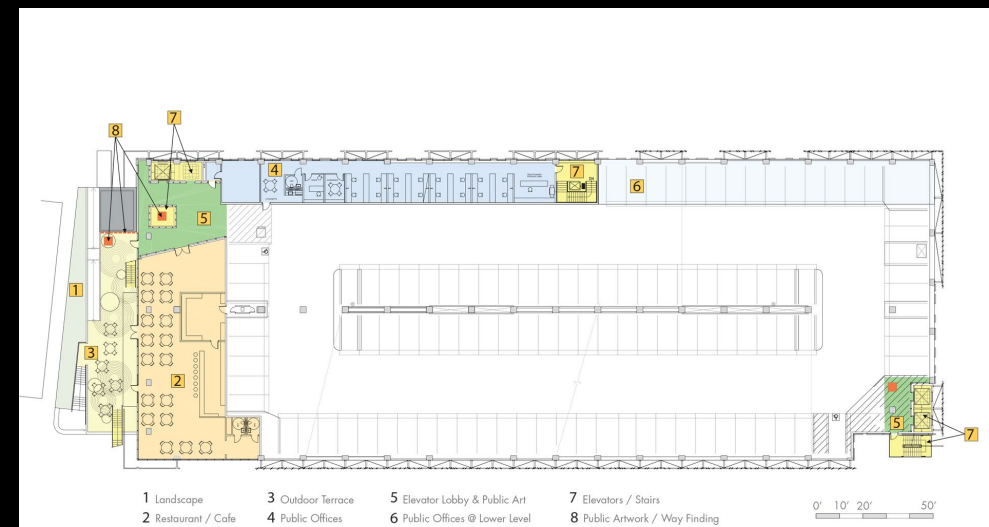

Design and Development Principles

5. Develop the 214 BUILDING as an Arts & Culture venue to provide community-wide programs.

Preliminary Recommendations:

- *Expand the uses and the Main and Meadow street presence of the 214 building.*
- *Establish Main St. as an active connector from the 214 building to Emma Ave.*
- *Reconfigure and landscape Holcomb St and Shiloh St as gateways from Maple Ave.*
- *Develop a parking structure and liner building with artist studio's and housing west of the 214 building.*
- *Close Blair St between Meadow Ave and Grove Ave.*
- *Create an exterior community events and gathering space as part of the redevelopment of the 214 building and permit the option to close Main Street 214 to sponsor a Public Art program along the Greenway and in downtown.*

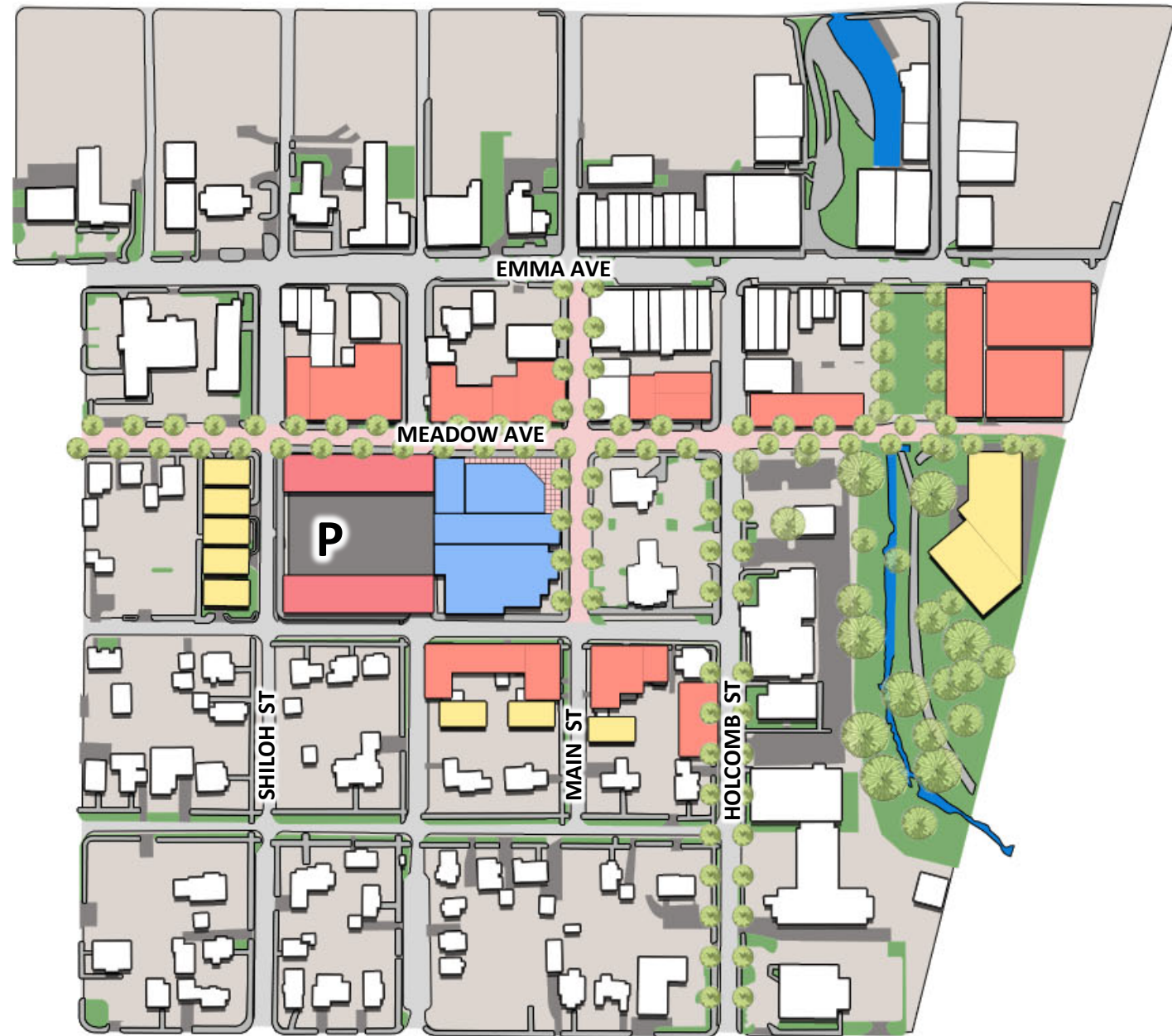

Design and Development Principles

5. Develop the 214 BUILDING as an Arts & Culture venue to provide community-wide programs.

Preliminary Recommendations:

- *Expand the uses and the Main and Meadow street presence of the 214 building.*
- *Establish Main St. as an active connector from the 214 building to Emma Ave.*
- *Reconfigure and landscape Holcomb St and Shiloh St as gateways from Maple Ave.*
- *Develop a parking structure and liner building with artist studio's and housing west of the 214 building.*
- *Close Blair St between Meadow Ave and Grove Ave.*
- *Create an exterior community events and gathering space as part of the redevelopment of the 214 building and permit the option to close Main Street 214 to sponsor a Public Art program along the Greenway and in downtown.*

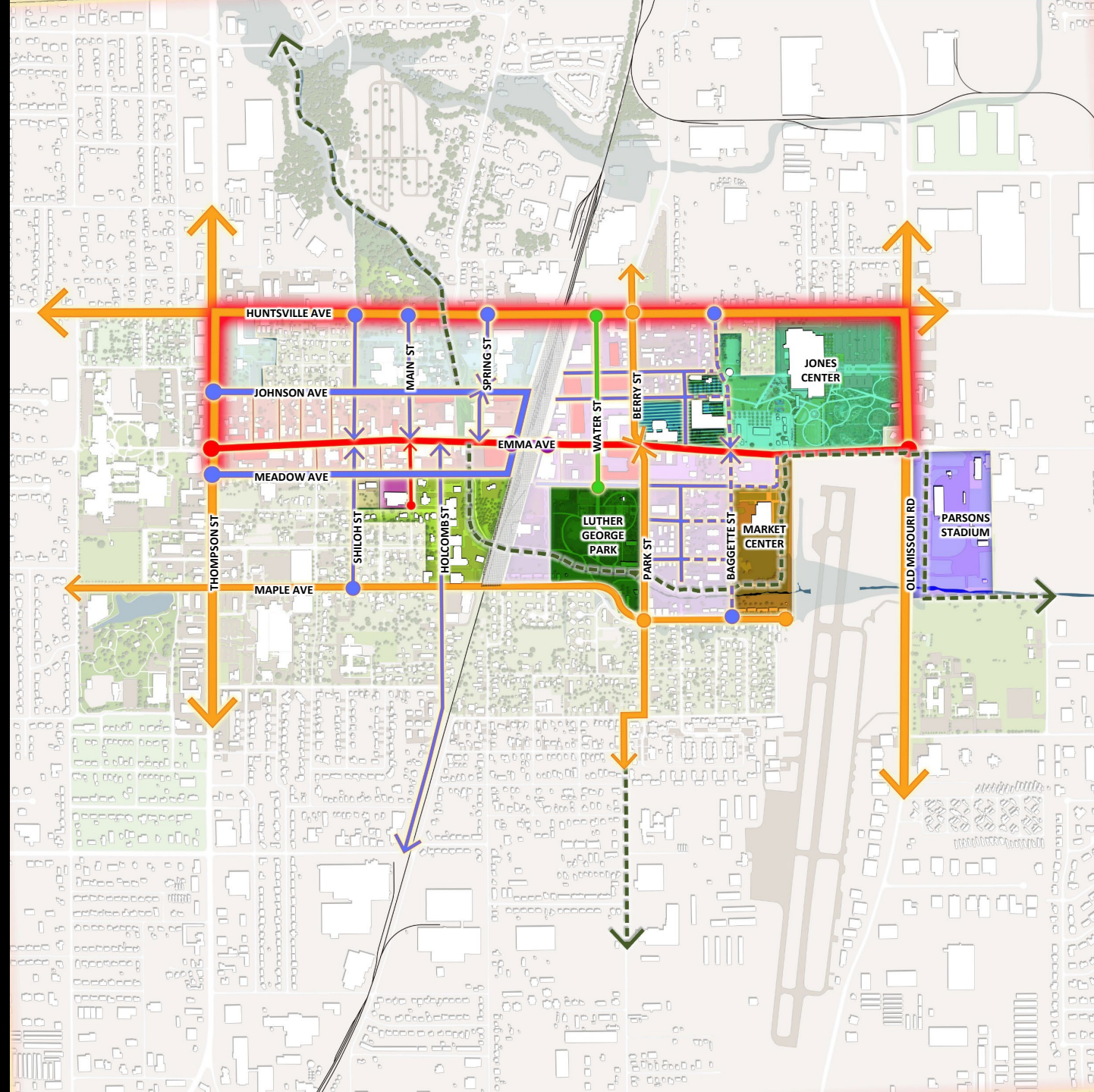

Design and Development Principles

6. Connect signature PUBLIC SPACES AND PARKS using SAFE STREETS.

Preliminary Recommendations:

- *Establish a public works improvement program throughout downtown to improve safety, lighting, sidewalks and landscape and connectivity to greenways and trails*
- *Create bike paths and sidewalks along major roads between key amenities and parks.*

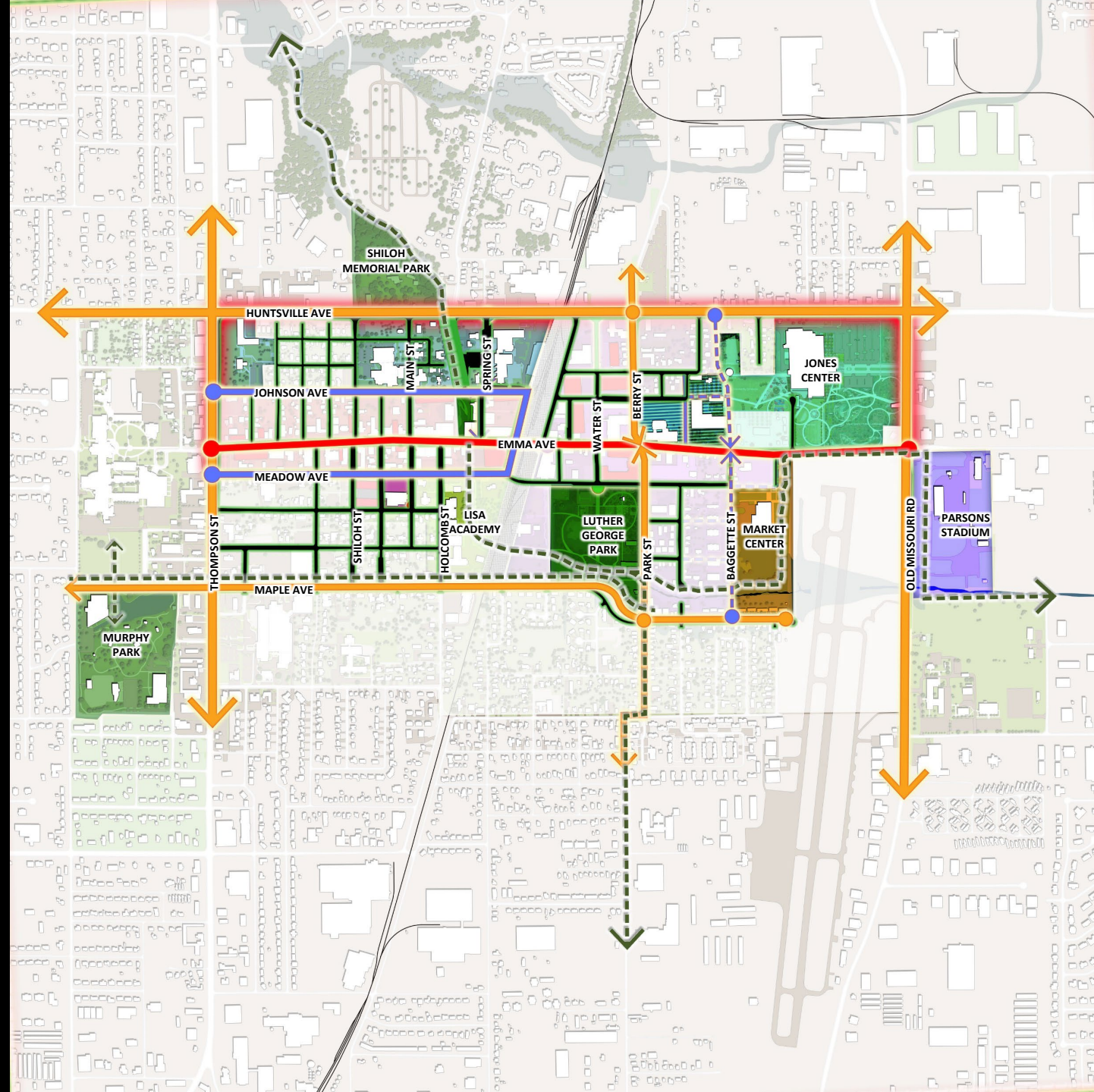

Design and Development Principles

Johnson Ave. and Meadow Ave Re-structuring



Design and Development Principles

7. Create a MULTI-MODAL DOWNTOWN ACCESS, CIRCULATION AND PARKING system.

Preliminary Recommendations:

- *Develop parking structures throughout downtown near key amenities and destinations.*
 - *At Meadow Ave and Shiloh St.*
 - *At Johnson Ave and N Commercial St.*
 - *At Johnson Ave. across from First United*
 - *At Center Ave. and Hewitt St.*
 - *At Berry St. and E Center Ave.*

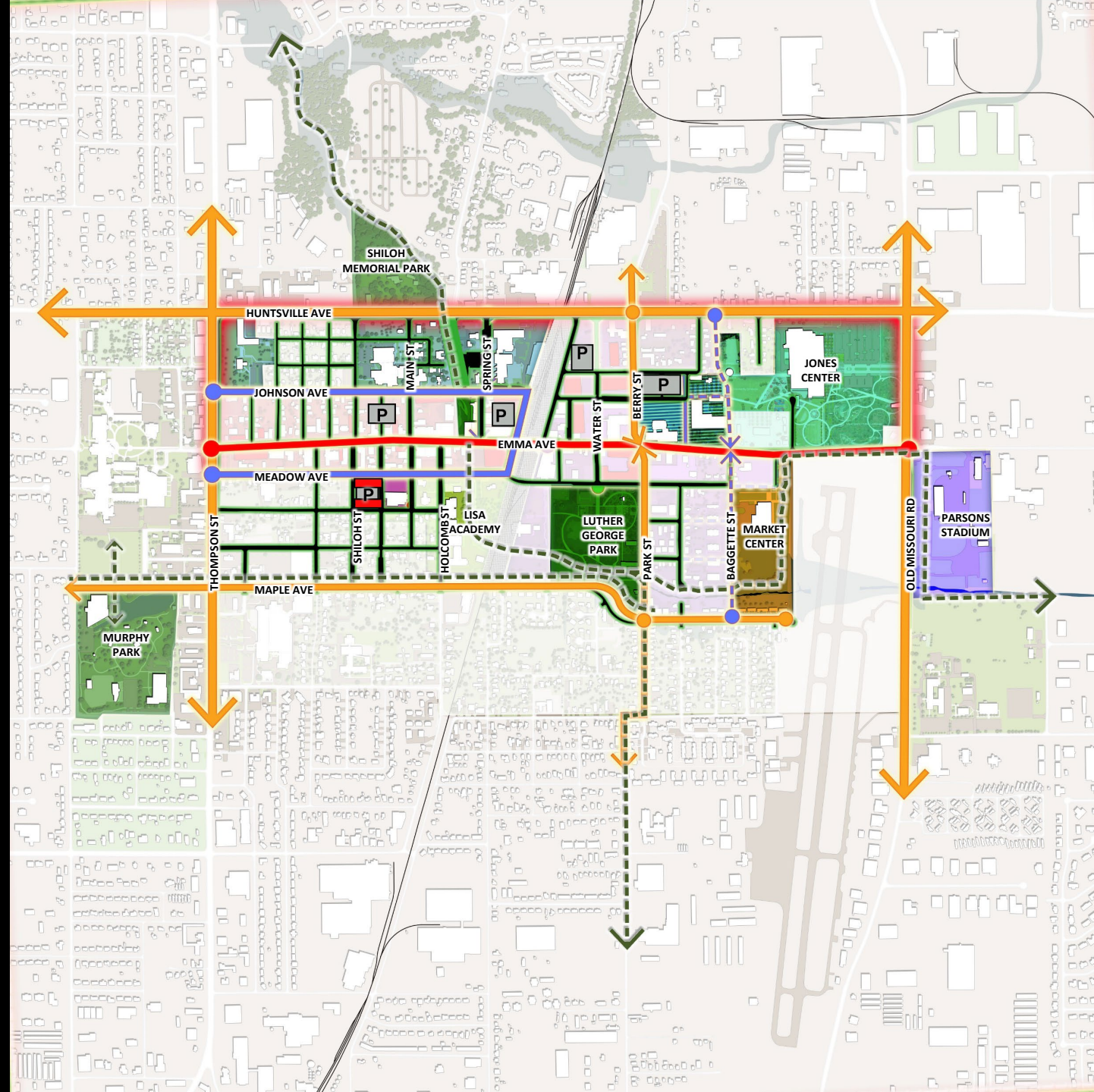

Design and Development Principles

8. Retain the EDUCATIONAL AND HEALTH INSTITUTIONS in Downtown.

Preliminary Recommendations:

- *Improve and support:*
 - *Lisa Academy*
 - *214 building*
 - *Northwest Medical Center*
 - *Downtown Community Clinic*
 - *Springdale Early Childhood Center*
 - *Jones Elementary School*
 - *Northwest Technical Institute*
 - *Springdale Public Library*

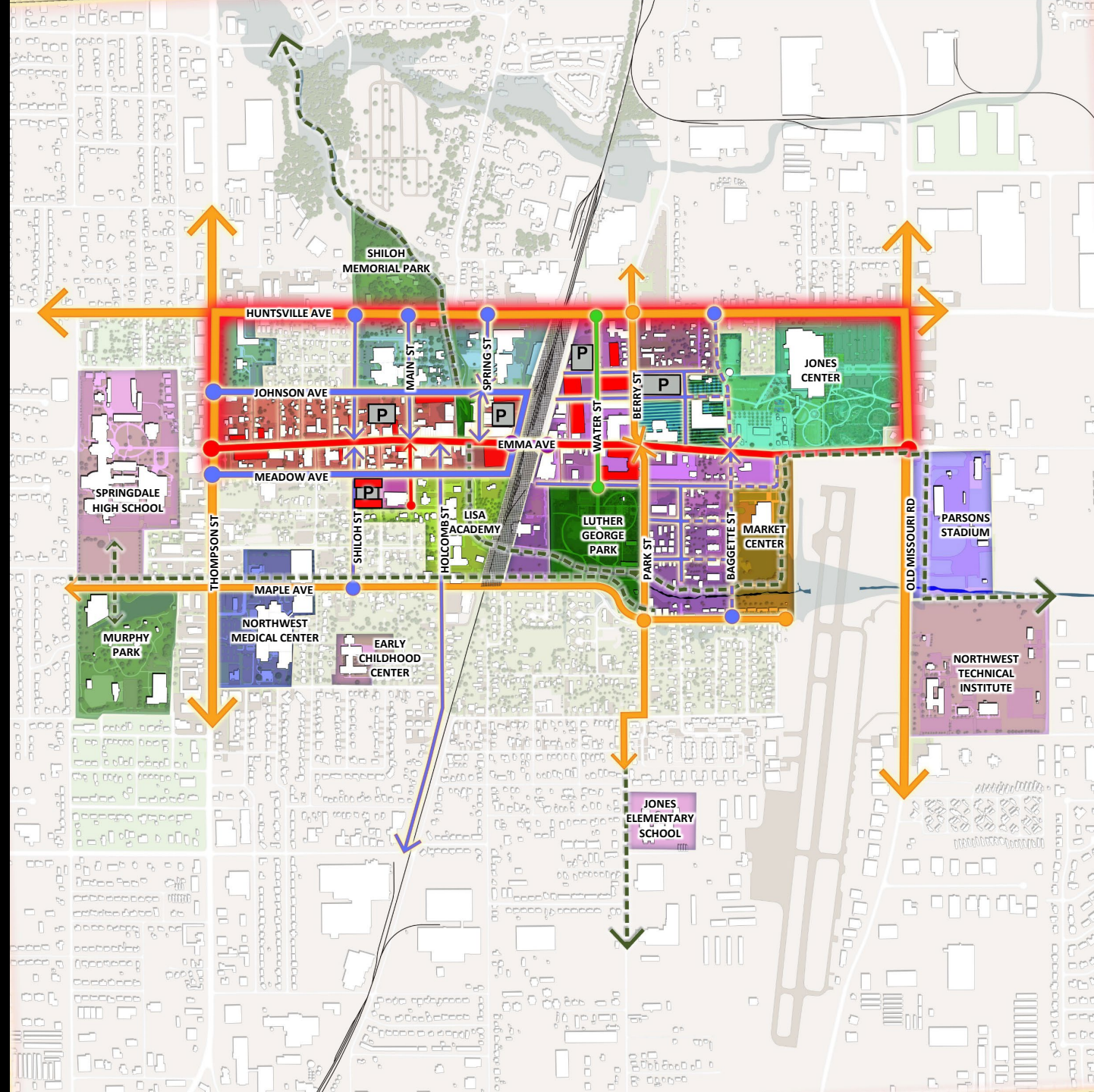

Design and Development Principles

9. Expand downtown and link to key ADJACENT PUBLIC AMENITIES AND EMPLOYMENT CENTERS.

Preliminary Recommendations:

- Support the growth of Springdale High School better connecting it to Emma Ave.
- Expand downtown to Sunset Ave. by creating a connection from Sunset Ave. to Springdale Municipal Airport.
- Expand programming and services at Parson Stadium and Northwest Technical Institute.
- Establish trail connections to Murphy Park, Springdale High School, and Tyson Foods.
- Improve the crossing at Thompson St. and Maple Ave. and Old MO Rd and Emma Ave.

